

IMUNDEX FOLD-SLIDE HANGING ROLLER SYSTEM INSTRUCTION

Accessories

Accessory	Image	Qty		Accessory	Image	Qty	
		1600-2400	2400-2600			1600-2400	2400-2600
Upper rollers and hinges for side folding doors		1	1	Plastic hinge		4	6
Upper rollers		1	1	Position template for plastic hinge		1	1
Down rollers for side folding doors		1	1	ST4*16 wooden screw		60	88
Stopper		1	1	10*1.5 arch self-adhesive pad (3M)		4	4
Full overlay hinge		4	3	Upper rail		Follow the cabinet size	
Full overlay non-soft closing hinge		0	3	Down rail		Follow the cabinet size	

Application and Installation Instruction

This folding system can be used to cover top panel and side panel of cabinet. Mainly apply to wooden doors or aluminum frame doors.

Diagram for 2-door folding(fixing side door)

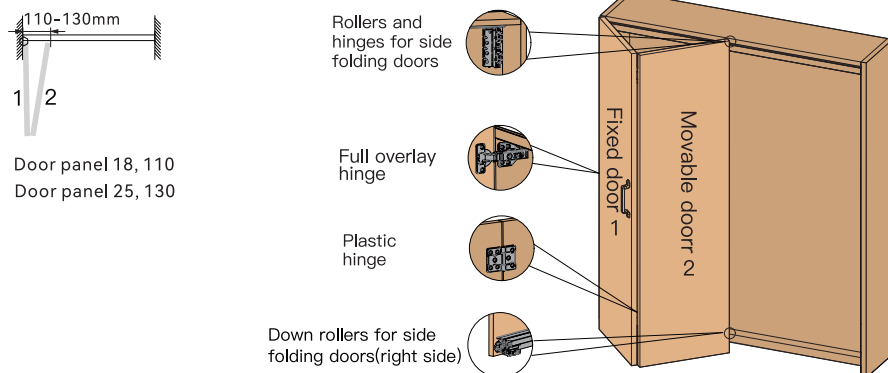

Instruction for switching left and right rollers

- 1、Down rollers for side folding doors: "L" upwards refers to left side opening.
- 2、Loose the M4 screws, rotate the hinge by 180° to have "R" upwards..
- 3、Align the holes, lock them with the long screws.
- 4、"R" upwards refers to right side opening.

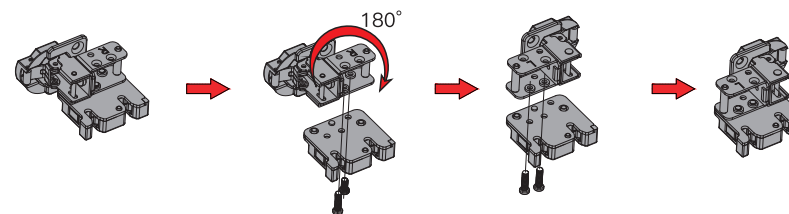

Installation paramaters (Take 2-door folding as an example)

1.Cabinet size

Door size:

2-door folding: width≤900mm, height≤2600mm, thickness 18-25mm.
Loading capacity: 2-door folding: ≤25kg per door.

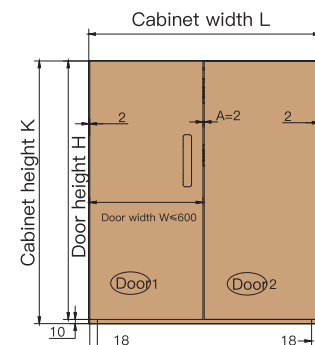

Top panel thickness C

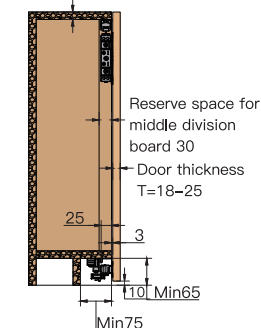

A:Reserve 2mm gap for plastic hinge installation

B:Reserve 2mm gap between the cabinet side board and the door side.

Door width :W= $\frac{L-6}{2} = \frac{(L-2-2*2)}{2}$, W≤600mm,

Door height :H=K-10,H≤2600mm

Middle division board reserve space Min 30mm

Bottom division board height Min 65mm

Bottom division board reserve Min 75mm

C refers to top panel thickness

⊕ refers to dia 35mm hinge cup hole, depth 12mm.

" " refers to pre-drilling holes for plastic hinge (A holes in drilling template)

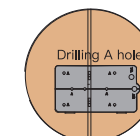

2. Dimension for drilling holes.

Door height 1600mm-2400mm

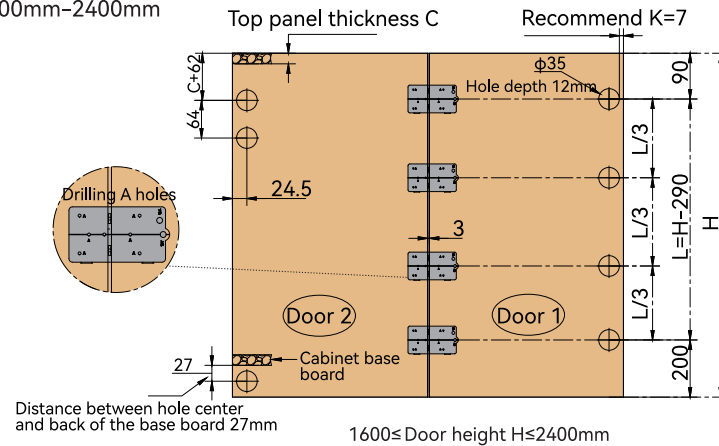

Door height 2400mm-2600mm

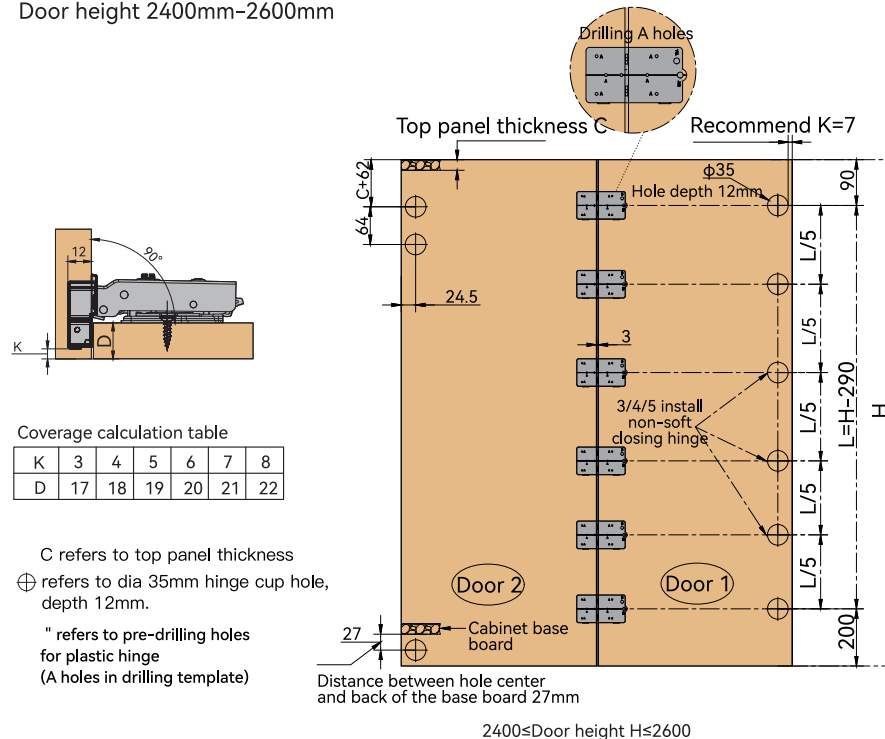

Installation steps

1. Install the rails and the related accessories. Fix the hinge plate on side panel of the fixed door. Install the upper rail: Place the roller, stopper into the rail and fix the rail with self-tapping screws. Install the down rail: the bottom panel can be pre-drilled. Place the down roller accessories into the rail and fix the rail from the top of the bottom panel with self-tapping screws; Note: Before installation, ensure that the inner surface of the track is clean and free of impurities. Check and confirm the rollers are free from damages or scratches, can slide smoothly.

The stopper should be installed with same direction as the door opening direction.

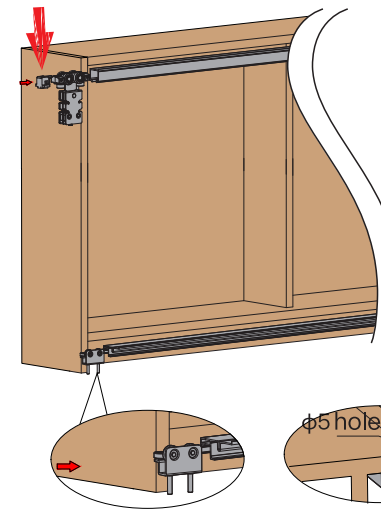

Install the hinge plates.

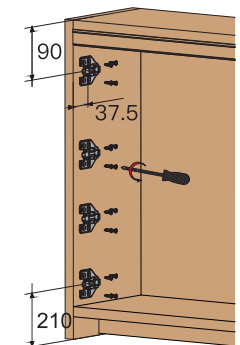

Pre-drilled hole

2. Install the full overlay hinges, plastic hinges, rollers for side folding doors according to the instruction as below and the Installation parameters mentioned above.

Pay attention to the installation direction of the plastic hinge. The 3-hole side is on the fixed door.

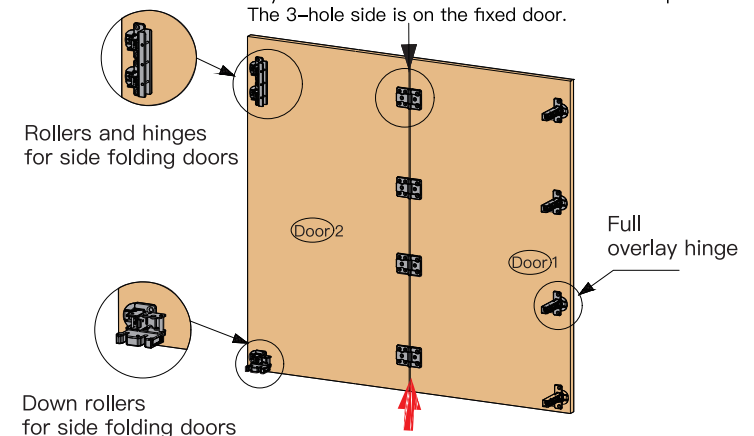

The installation direction of plastic hinges must be same.

3. Hang the door. Connect the door 1,2 with the roller accessories and adjust the door gaps.

3.1 Install the hinges on side door. Align the hinge to the plate and press it, as the below picture shows.

The hinges are clip on hinges, used to fix door 1.

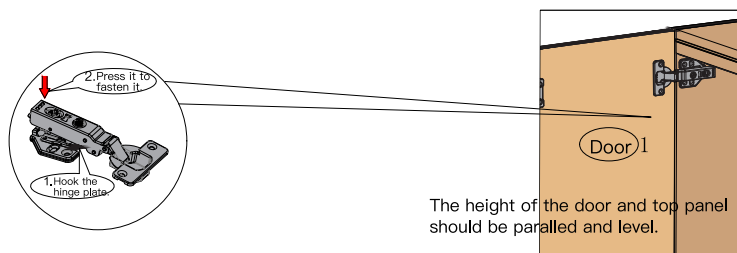

3.2 Hang the upper roller hinge of door 2 on the second hanging roller accessories.

Lift the door upwards slightly to have easier installation.

Fasten the bottom screws anticlockwise after connection.

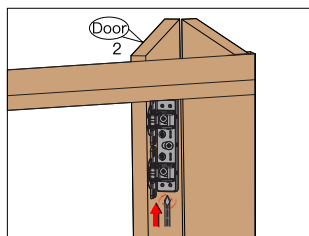

3.3 Connect the down roller of door 2 with the roller on down rail which is close to the fixed door.

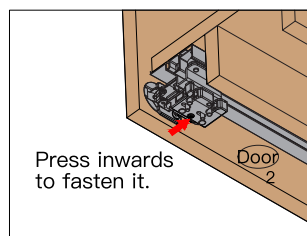

3.4 Adjust the doors

If the doors are not horizontal, can adjust the screws on hinge, middle folding door hinges, side folding door hinges. To have up and down, forward and backward, left and right djustment by $\pm 2.5\text{mm}$.

Left and right adjustment for coverage between door and side panel.

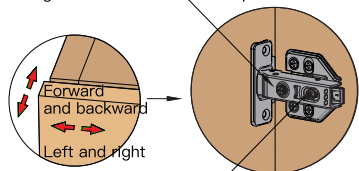

Forward and backward adjustment for gap between door and cabinet.

Up and down adjustment for parallel between door and top panel.

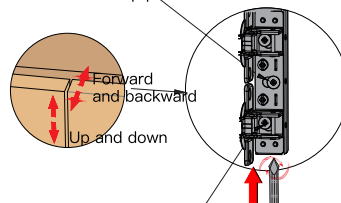

Forward and backward adjustment for gap between door and cabinet.

3.5 Install the decorative cover. Installation completed.

