

This instruction is fit for the following item numbers

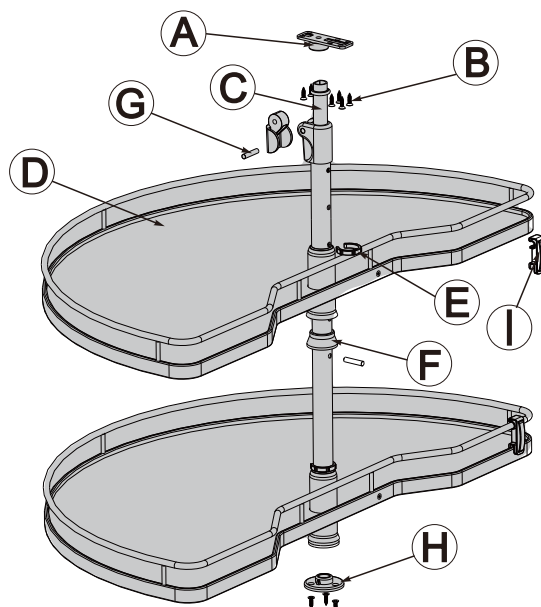

| Name | T=Cabinet | Width*Depth*Height |
|--------------------|-----------|--------------------|
| 180°Revoling baske | 900 mm | 750*420(600-700) |

parts list

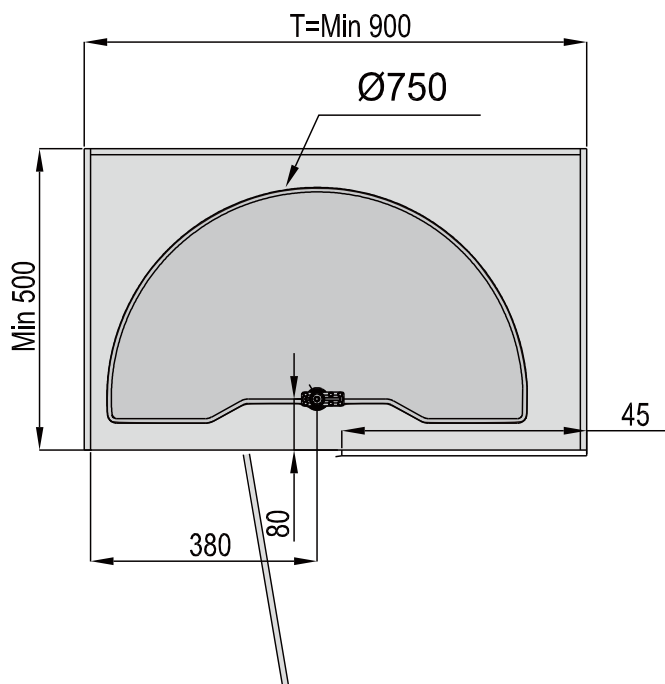
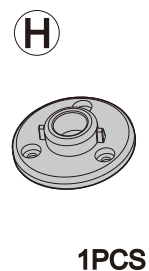
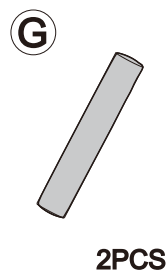
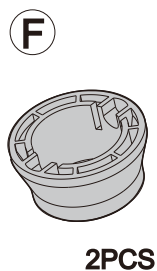
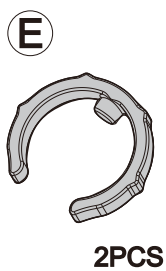
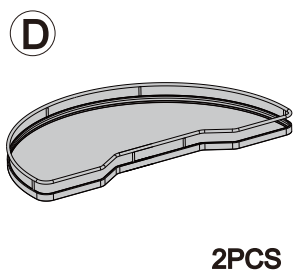
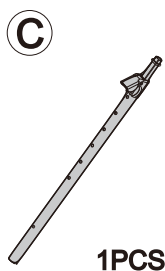
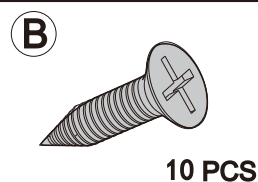
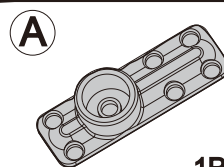

Step 1

- 1.1** As shown, drill a $\phi 5 \times 10$ mm hole in the left bottom cabinet, make a mark in the top cabinet and install the bottom fixing glue and top fixing glue.

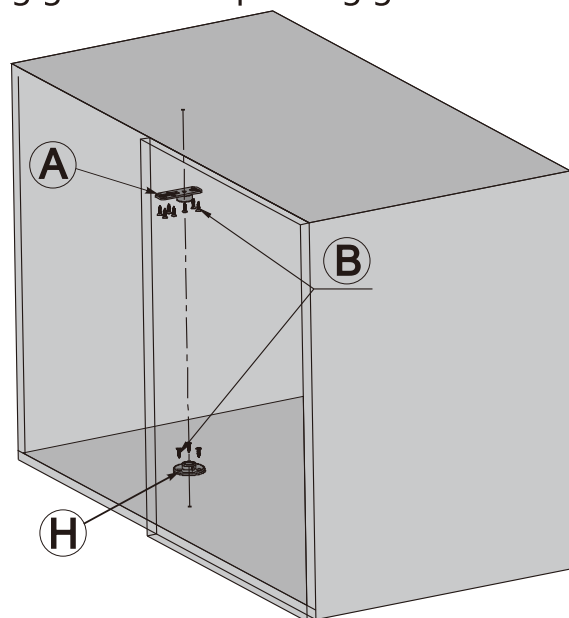
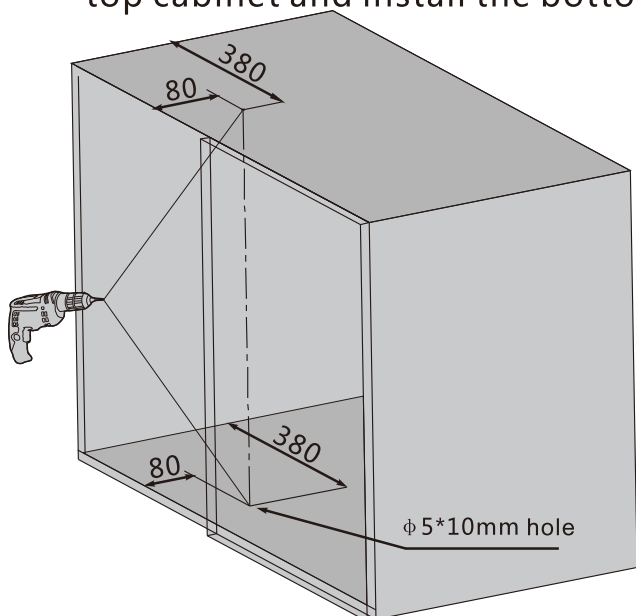

Step 2

2.1 Install the product into the cabinet.

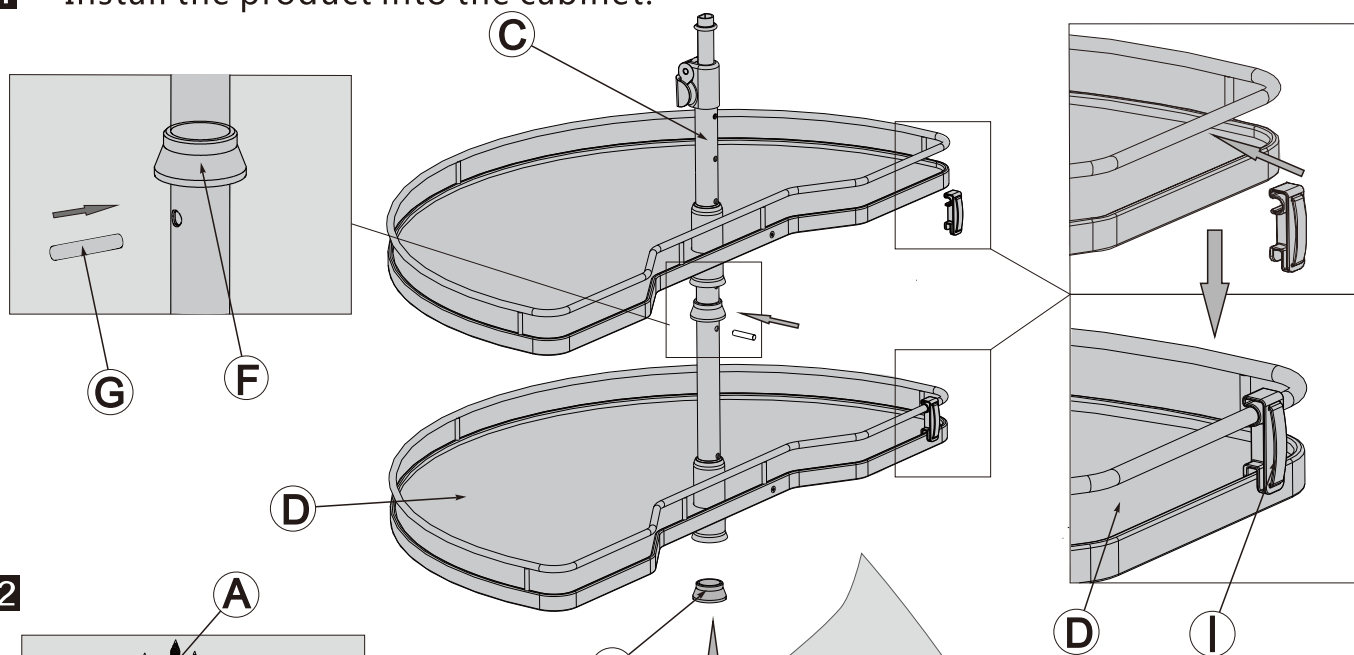

2.2

