

► Clip-on, Opening 165° soft close hinge

TECHNICAL SPECIFICATION

- Wide open 165° Soft close hinge
- 165° opening angle for Door thickness of 14-26mm
- Metal/zinc alloy material, Cu-Nickel/Cu-black nickel plated
- Integrated silent system
- Small angle soft close
- 3-dimensional adjustment (with cam plate)



ARM INSTALLATION/ADJUSTMENT

Full Overlay - Code: 7173165



Half Overlay - Code: 7172166



Inset - Code: 7171167



DRILLING FOR CUP

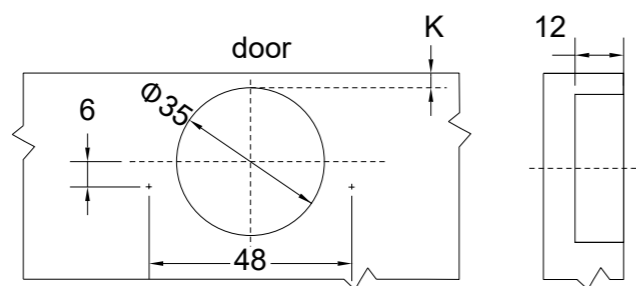

CUP INSTALLATION

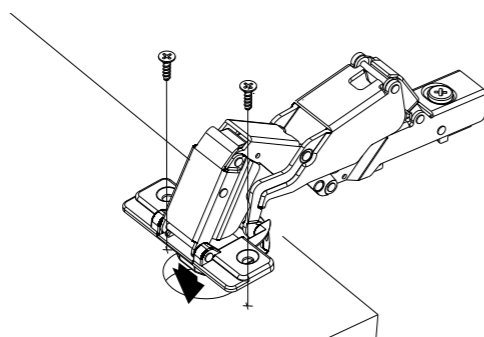

Wood screws

► Clip-on, Opening 165° soft close hinge

OVERLAY TABLE

Full Overlay		Half Overlay		Inset																																																																														
$H=14+K-D$ D: maximum value		$H=4+K-D$ D: maximum value		$H=0+K+A$																																																																														
<table border="1"> <tr><th>D</th><th>K</th><th>3</th><th>4</th><th>5</th><th>6</th><th>7</th></tr> <tr><th>0</th><td>17</td><td>18</td><td>19</td><td>20</td><td>21</td><td></td></tr> <tr><th>2</th><td>15</td><td>16</td><td>17</td><td>18</td><td>19</td><td></td></tr> <tr><th>4</th><td>13</td><td>14</td><td>15</td><td>16</td><td>17</td><td></td></tr> </table>	D	K	3	4	5	6	7	0	17	18	19	20	21		2	15	16	17	18	19		4	13	14	15	16	17			<table border="1"> <tr><th>D</th><th>K</th><th>3</th><th>4</th><th>5</th><th>6</th><th>7</th></tr> <tr><th>0</th><td>7</td><td>8</td><td>9</td><td>10</td><td>11</td><td></td></tr> <tr><th>2</th><td>5</td><td>6</td><td>7</td><td>8</td><td>9</td><td></td></tr> <tr><th>4</th><td>3</td><td>4</td><td>5</td><td>6</td><td>7</td><td></td></tr> </table>	D	K	3	4	5	6	7	0	7	8	9	10	11		2	5	6	7	8	9		4	3	4	5	6	7			<table border="1"> <tr><th>A</th><th>K</th><th>3</th><th>4</th><th>5</th><th>6</th><th>7</th></tr> <tr><th>2</th><td>-1</td><td>-2</td><td>-3</td><td>-4</td><td>-5</td><td></td></tr> <tr><th>4</th><td>1</td><td>0</td><td>-1</td><td>-2</td><td>-3</td><td></td></tr> </table>	A	K	3	4	5	6	7	2	-1	-2	-3	-4	-5		4	1	0	-1	-2	-3		
D	K	3	4	5	6	7																																																																												
0	17	18	19	20	21																																																																													
2	15	16	17	18	19																																																																													
4	13	14	15	16	17																																																																													
D	K	3	4	5	6	7																																																																												
0	7	8	9	10	11																																																																													
2	5	6	7	8	9																																																																													
4	3	4	5	6	7																																																																													
A	K	3	4	5	6	7																																																																												
2	-1	-2	-3	-4	-5																																																																													
4	1	0	-1	-2	-3																																																																													

MINIMUM REVEAL TABLE

A	T	14	15	16	17	18	19	20	21	22	23	24	25	26
3	0.0	0.0	0.0	0.0	0.0	0.0	0.0	0.0	0.5	1.0	1.6	2.1	2.7	
4	0.0	0.0	0.0	0.0	0.0	0.0	0.0	0.0	0.3	0.9	1.4	2.0	2.5	
5	0.0	0.0	0.0	0.0	0.0	0.0	0.0	0.0	0.1	0.7	1.2	1.8	2.3	
6	0.0	0.0	0.0	0.0	0.0	0.0	0.0	0.0	0.0	0.5	1.1	1.6	2.2	
7	0.0	0.0	0.0	0.0	0.0	0.0	0.0	0.0	0.0	0.4	0.9	1.5	2.0	

K Boring distance
 T Door thickness
 A Minimum gap (A) for door with a door edge radius
 L Gap between door and panel

Note: above parameter based on the door edge is right-angle side, if the door is round corner edge, the parameter value will be reduce according to the edge size.

HINGE ADJUSTMENT

Depth Adjustment	Overlay Adjustment	Height Adjustment
Rotate depth screw to adjust door gap. Adjust range : 3.8mm	Rotate lateral screw to increase or decrease door overlay. Adjust range : 6mm	Adjust the mounting plate on panel to adjust the door's height.

Notice: The reference adjustment range is the product design range, the actual size of the cabinet and the drilling method may have a certain impact on the parameters.